

Trantorque®
Micro
 Inch and Metric

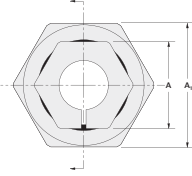

Integrated Bore

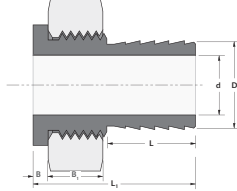

Smooth Bore

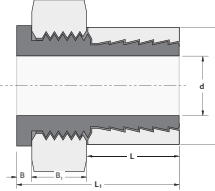

TOLERANCE (T_L)

T_L for shaft and bore is 01-.0015"
 (.04mm) for all sizes

Trantorque Micro – Inch

Size	d	Integrated Bore Di	Smooth Bore Ds	L	L1	Wrench Size		B	B1	Ma Install Torque	Shipping Weight	Mt	Thrust	Smooth Bore Hub Pressure	A	A1
						Torque	Thrust									
(in)	(in)	(in)	(in)	(in)	(in)	(in)	(in)	(in)	(in)	(in-lb)	(lb)	(in-lb)	(lb)	(psi)		
1/8	0.125	0.369	0.563	0.38	0.67	7/16	11/16	0.06	0.22	125	0.050	46	738	9275	0.4375	0.6875
3/16	0.188	0.369	0.613	0.38	0.67	7/16	11/16	0.06	0.22	150	0.052	83	885	10221	0.4375	0.6875
1/4	0.250	0.369	0.613	0.38	0.67	7/16	11/16	0.06	0.22	150	0.048	111	885	10221	0.4375	0.6875
5/16	0.313	0.431	0.625	0.44	0.76	1/2	3/4	0.06	0.25	150	0.057	120	771	7478	0.5	0.75
3/8	0.375	0.550	0.750	0.44	0.83	5/8	15/16	0.06	0.31	150	0.099	116	620	5008	0.625	0.9375
7/16	0.438	0.550	0.750	0.50	0.92	5/8	15/16	0.09	0.31	150	0.096	136	620	4387	0.625	0.9375
1/2	0.500	0.666	0.875	0.63	1.11	3/4	1 1/8	0.09	0.38	225	0.167	194	777	3767	0.75	1.125
9/16	0.563	0.666	0.875	0.75	1.25	3/4	1 1/8	0.11	0.38	225	0.164	218	777	3139	0.75	1.125
5/8	0.625	0.791	1.000	0.94	1.52	7/8	1 5/16	0.13	0.44	300	0.276	280	895	2533	0.875	1.3125

Trantorque Micro – Metric

16Size	d	Integrated Bore Di	Smooth Bore Ds	L	L1	Wrench Size		B	B1	Ma Install Torque	Shipping Weight	Mt	Thrust	Smooth Bore Hub Pressure	A	A1
						Torque	Thrust									
(mm)	(mm)	(mm)	(mm)	(mm)	(mm)	(mm)	(mm)	(mm)	(mm)	(Nm)	(kg)	(Nm)	(kN)	(N/mm ²)		
3	3	9.37	14.29	9.5	17.0	12.0	17.0	1.5	5.6	14	0.023	5	3.3	64	0.4375	0.6875
4	4	9.37	14.29	9.5	17.0	12.0	17.0	1.5	5.6	17	0.022	8	3.9	77	0.4375	0.6875
5	5	9.37	15.56	9.5	17.0	12.0	17.0	1.5	5.6	17	0.023	10	3.9	70	0.4375	0.6875
6	6	9.37	15.56	9.5	17.0	12.0	17.0	1.5	5.6	17	0.022	12	3.9	70	0.4375	0.6875
7	7	10.95	15.56	9.5	17.8	13.0	19.0	1.5	6.4	17	0.025	12	3.4	61	0.5	0.75
8	8	10.95	15.88	11.1	19.4	13.0	19.0	1.5	6.4	17	0.026	14	3.4	52	0.5	0.75
9	9	13.97	19.05	11.1	21.0	16.0	23.0	1.5	7.9	17	0.046	12	2.8	35	0.625	0.9375
10	10	13.97	19.05	12.7	23.4	16.0	23.0	2.4	7.9	17	0.047	14	2.8	30	0.625	0.9375
11	11	13.97	19.05	12.7	23.4	16.0	23.0	2.4	7.9	17	0.044	15	2.8	30	0.625	0.9375
12	12	13.97	19.05	12.7	23.4	16.0	23.0	2.4	7.9	17	0.041	17	3.6	40	0.625	0.9375
13	13	16.92	22.23	15.9	28.2	20.0	28.0	2.4	9.5	25	0.074	22	3.5	26	0.75	1.125
14	14	16.92	22.23	19.1	31.8	20.0	28.0	2.8	9.5	25	0.076	24	3.5	22	0.75	1.125
15	15	16.92	22.23	19.1	31.8	20.0	28.0	2.8	9.5	25	0.071	26	3.5	22	0.75	1.125
16	16	20.09	25.40	23.8	38.5	23.0	33.0	3.2	11.1	34	0.124	32	4.0	17	0.875	1.3125

*All Trantorque Micro orders are subject to a 25 piece minimum.