

HVAC

BELTS | PULLEYS | TENSIONERS | KEYLESS LOCKING DEVICES



Upgrade the performance of your HVAC Systems



The long-lasting upgrade to rubber belts – combining the performance of a rubber belt with additional cost-saving benefits:

Fast, Easy Installation

- Easy to use twist-lock design is made to length by hand
- Great for captive and fixed center drives
- Drops right in to existing equipment

Longer Belt Life

- Withstands extreme temperatures -40°F to +240°F (-40°C to +116°C)
- Unaffected by oil, grease, water & common industrial solvents
- High resistance to abrasion and shock loads

Simple Inventory Management

- Less money tied up in spare endless belts
- Always have the right belt length on hand
- Available in red classical V and blue wedge profiles

Classical Profiles



Z/10, 3L, A/4L/13,
B/5L/17, C/22, D/32

Wedge Profiles



3V, 5V, SPZ, SPA, SPB

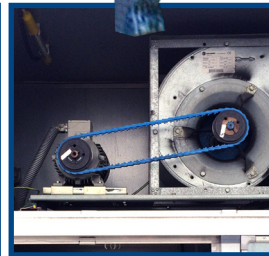
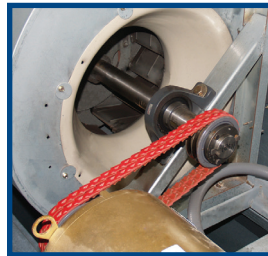
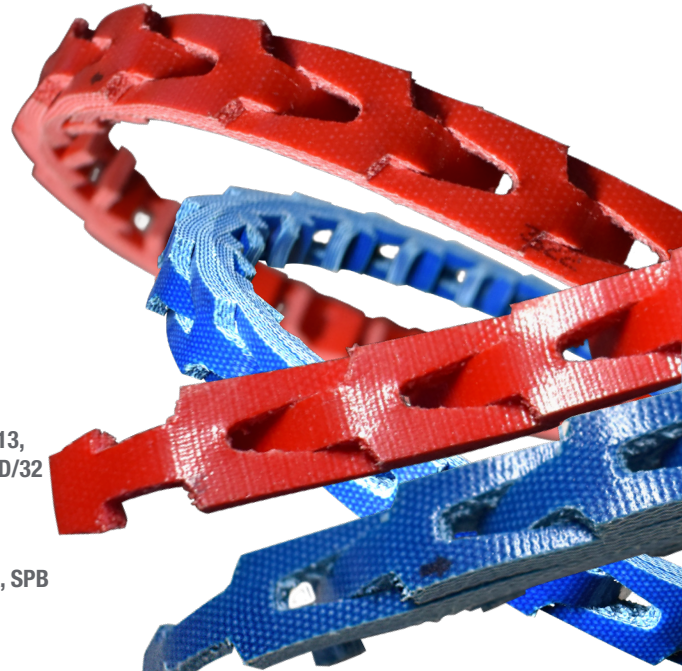

Automatically take the slip out of drive systems - decreasing downtime, reducing operating costs and saving energy.

Reduce Maintenance and Noise

- Increases belt life
- No belt retensioning
- Eliminates noise and vibration

Easy Belt Installation

- Allows belt to be installed without tools or moving components

Dependability When it Counts Most

- Constructed of quality materials for proven durability in harsh environments
- Available for single and multiple strand belt and chain drives

Light Duty

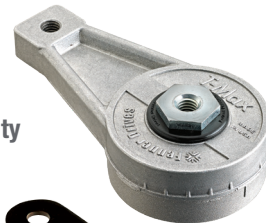

Medium Duty



Heavy Duty



Mounting Bracket

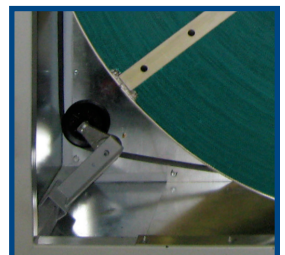
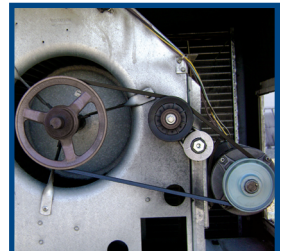
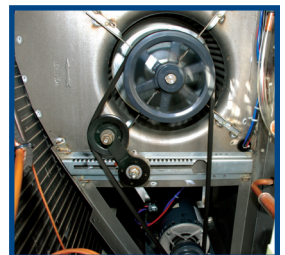

Trantorque® Keyless Locking Devices

Provides a zero-backlash shaft-to-hub connection with none of the operational drawbacks of keyways, shrink fits, splines, or set screws.

Straight Hub Bore Designs

- Easier and less expensive to manufacture than taper bores required for alternative bushings

Fast, Easy Installation

- Single locking nut for quick installation, adjustments and better alignment

Extensive Inventory

- Same day shipping on stock bore sizes 1/8" – 3", 3 – 75mm

Customized Applications

- Common outside diameters and variable inside diameters to match your stock components

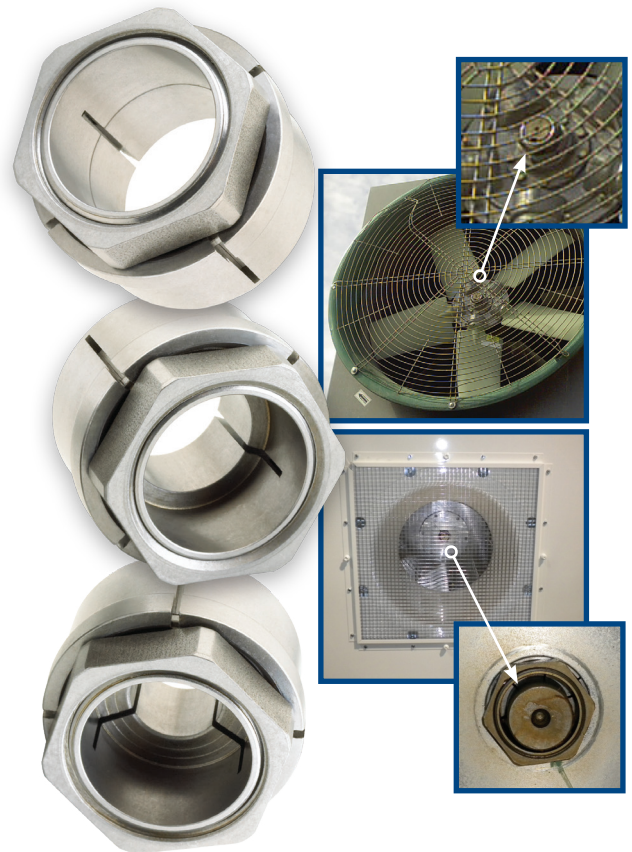

PowerMax™ Composite Pulleys & Idlers

Used where dependability counts the most!

Consistent Strength

- Glass-reinforced nylon is a versatile engineered thermoplastic with high temperature and abrasion resistance

Energy Savings

- Light-weight composite design means less energy for start-up and run times

Corrosion Resistant

- Perfect for applications exposed to extreme elements – increased life vs. steel or cast iron

Design Flexibility

- Wide range of engineered composite material options to best fit your application



